



DEEP CYCLE
SERIES: 5000
MODEL: 8 CH 23 P

BATTERY ENGINEERING
WWW.ROLLSBATTERY.COM MADE IN CANADA

BATTERY TYPE: 8 VOLTS

DIMENSIONS:

LENGTH	718 MM	28 1/4 INCHES
WIDTH	210 MM	8 1/4 INCHES
HEIGHT	464 MM	18 1/4 INCHES

WEIGHTS:

WEIGHT DRY	92 KG	202 LBS.
WEIGHT WET	116 KG	256 LBS.

CONTAINER CONSTRUCTION:

CONTAINER: (INNER)	POLYPROPYLENE	TERMINALS:	FLAG WITH STAINLESS STEEL NUTS AND BOLTS
COVER: (INNER)	POLYPROPYLENE - HEAT SEALED TO INNER CONTAINER	HANDLES:	MOLDED
CONTAINER: (OUTER)	HIGH DENSITY POLYETHYLENE		
COVER: (OUTER)	HIGH DENSITY POLYETHYLENE SNAP FIT TO OUTER CONTAINER		

PLATES:

POSITIVE PLATE DIMENSION:

HEIGHT	270 MM	10.625 INCHES
WIDTH	143 MM	5.625 INCHES
THICKNESS	3.81 MM	0.150 INCHES

CELLS: 4 **PLATES/CELL:** 23

NEGATIVE PLATE DIMENSION:

HEIGHT	270 MM	10.625 INCHES
WIDTH	143 MM	5.625 INCHES
THICKNESS	3.05 MM	0.120 INCHES

SEPARATOR: THICKNESS 3 MM 0.105 INCHES

INSULATION: GLASS MAT 1 MM 0.020 INCHES

CAPACITY:

CRANK AMPS:		
COLD (CCA)	0°F / -17.8°C	1866
MARINE (MCA)	32°F / 0°C	2333

ELECTROLYTE RESERVE: ABOVE PLATES 95 MM 3.75 INCHES

RESERVE CAPACITY: RC @ 25A 969 MINUTES

20 HR RATE: 605 50% DOD

	HOUR RATE	SPECIFIC GRAVITY	CAP / AH	CURRENT / AMPS
CAPACITY @	100 HOUR RATE	1.280 SP. GR.	853	8.53
CAPACITY @	72 HOUR RATE	1.280 SP. GR.	805	11.18
CAPACITY @	50 HOUR RATE	1.280 SP. GR.	744	14.88
CAPACITY @	24 HOUR RATE	1.280 SP. GR.	629	26.2
CAPACITY @	20 HOUR RATE	1.280 SP. GR.	605	30.3
CAPACITY @	15 HOUR RATE	1.280 SP. GR.	563	37.5
CAPACITY @	12 HOUR RATE	1.280 SP. GR.	526	43.9
CAPACITY @	10 HOUR RATE	1.280 SP. GR.	502	50.2
CAPACITY @	8 HOUR RATE	1.280 SP. GR.	472	59.0
CAPACITY @	6 HOUR RATE	1.280 SP. GR.	430	71.6
CAPACITY @	5 HOUR RATE	1.280 SP. GR.	405	81
CAPACITY @	4 HOUR RATE	1.280 SP. GR.	375	94
CAPACITY @	3 HOUR RATE	1.280 SP. GR.	339	113
CAPACITY @	2 HOUR RATE	1.280 SP. GR.	290	145
CAPACITY @	1 HOUR RATE	1.280 SP. GR.	206	206



1 STATION RD SPRINGHILL, NOVA SCOTIA CANADA B0M 1X0 1.800.681.9914

REV.2

Jan-10

8 CH 23 P

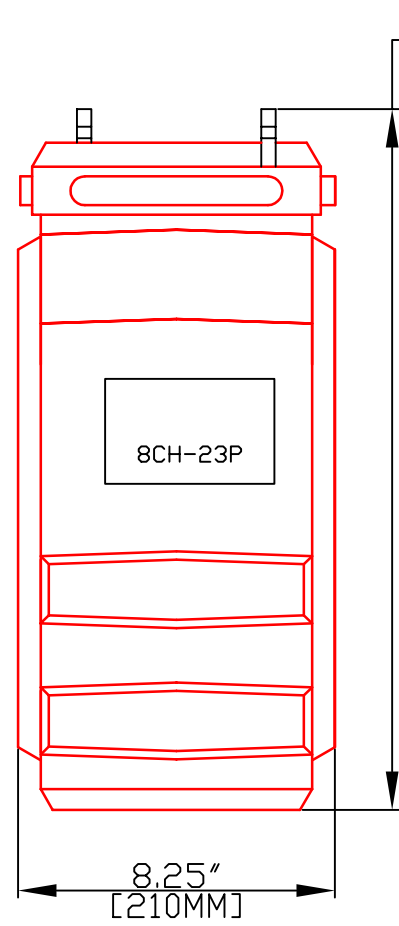
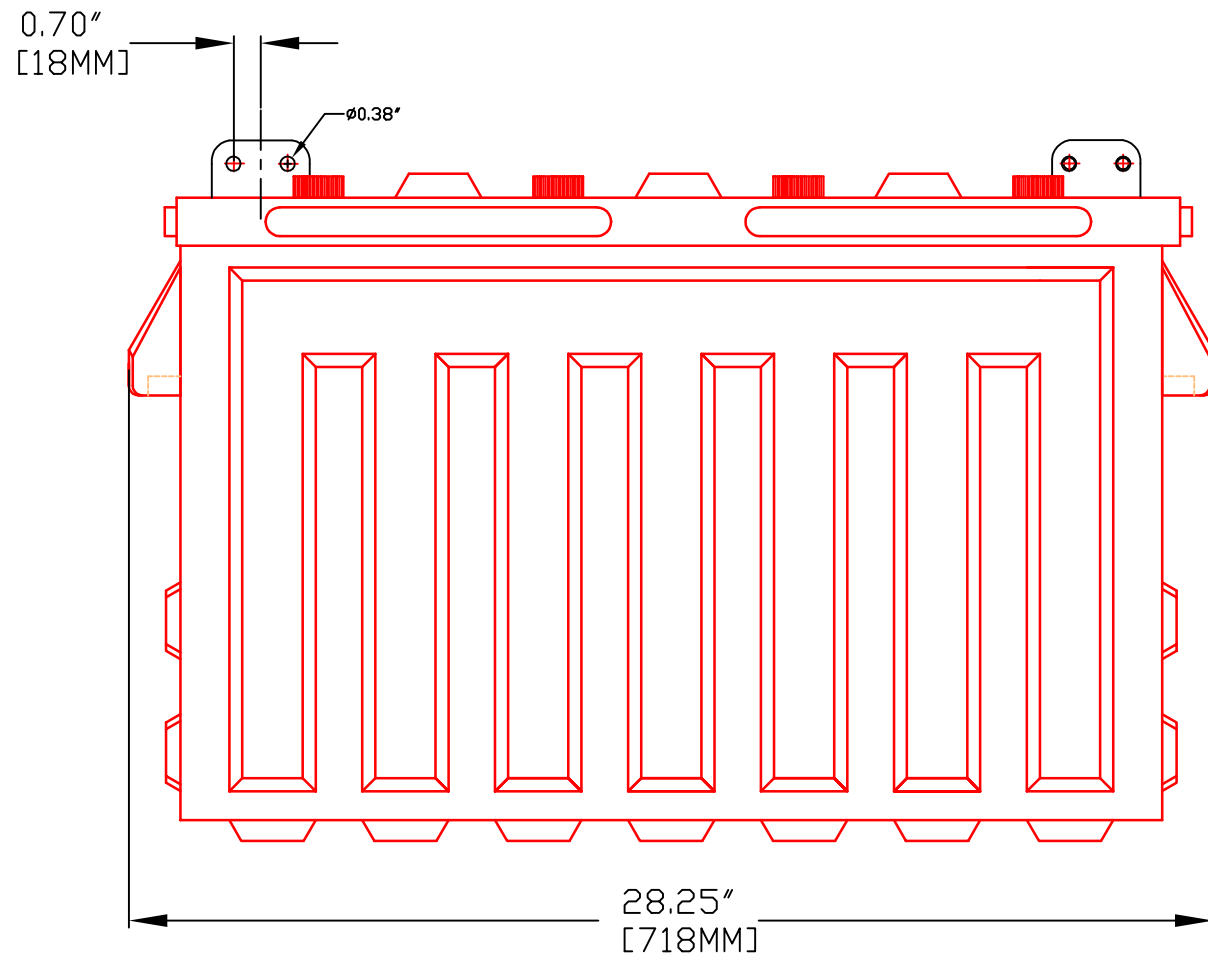
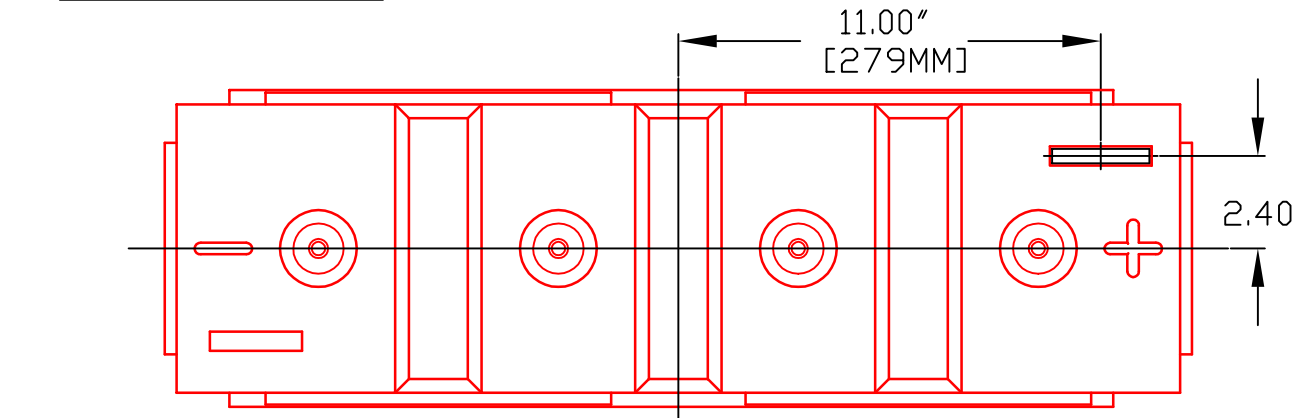

PART NUMBER: 8-CH-23P

WEIGHT WET: 256 LB / 116 KG

WEIGHT DRY: 202 LB / 92 KG

CAPACITY: 605 AH 20HR

VOLTAGE: 8 V

OVERALL DIMENSIONS: 28 1/4" X 8 1/4" X 18 1/4"

MAX HEIGHT WITH OPTIONAL HYDROCAPS: 18.63" / 473 MM



18.25" [464MM]

Rolls
BATTERY ENGINEERING

TITLE: 8CH23P

DESCRIPTION: 8V 5000 SERIES

CONTACT INFO:
WEB: WWW.ROLLSBATTERY.COM
E-MAIL: SALES@SURRETTE.COM
PHONE: 1-800-681-9914

SCALE: 1" = 6" 1" = 4" JPEG:
8.5" X 11" 11" X 17" NOT TO SCALE

Drawn by: S. WILES Approved By: J.D. SURRETTE

DATE: JAN-2010 REVISION 2

DRAWING NO.: DWG 014, BD8CH23P